

PROPOSED SITE AT PREMISES NO. 185, GURUCHARAN NASKAR ROAD, WARD NO. 114, BOROUGH NO. XI

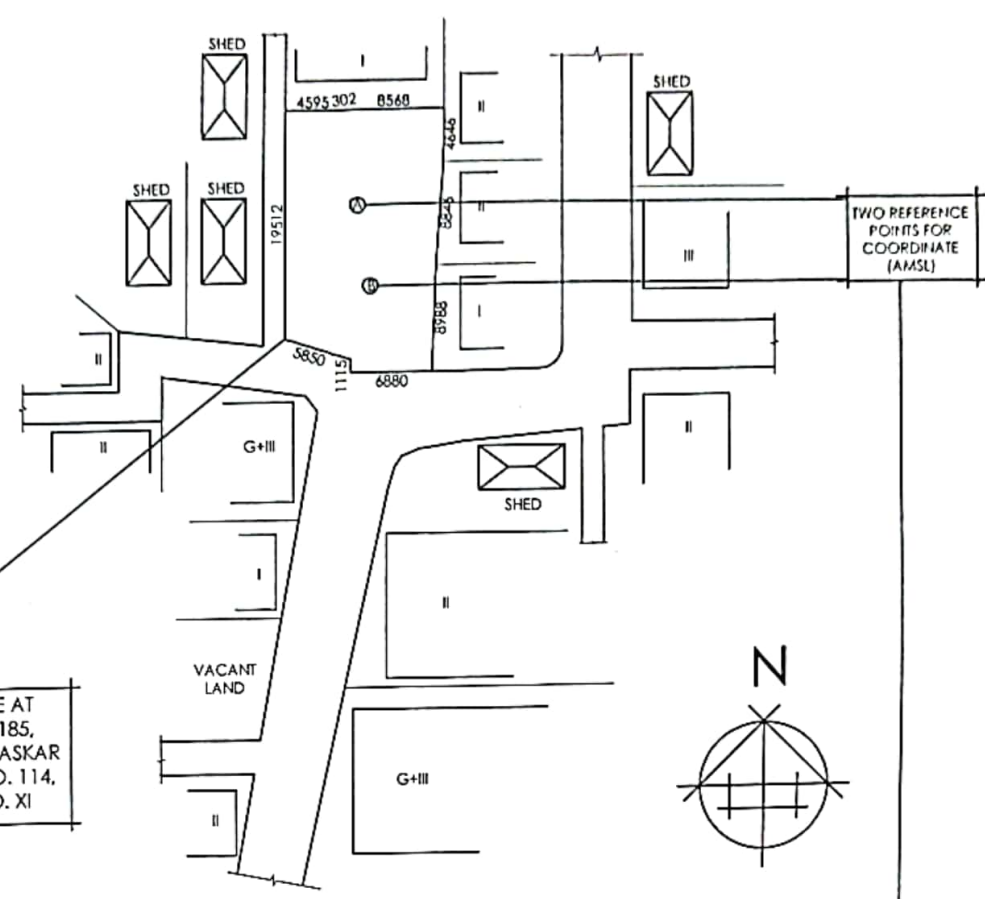

SITE PLAN
SCALE = 1:600

| REFERENCE POINTS MARKED IN THE SITE PLAN OF THE PROPOSAL | CO ORDINATE IN WGS 84 | | SITE ELEVATION (AMSL) |
|--|-----------------------|-----------|-----------------------|
| | LATITUDE | LONGITUDE | |
| A | 22.28 | 88.20 | 7 M. |
| B | 22.28 | 88.21 | 7 M. |

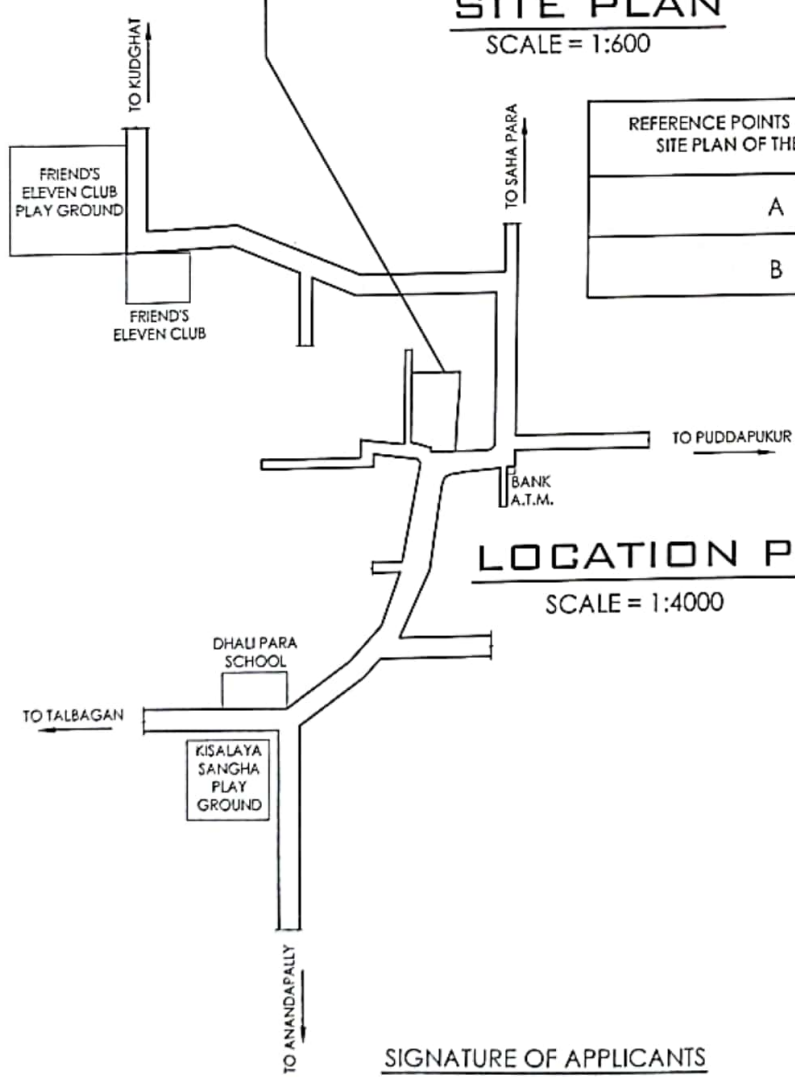

LOCATION PLAN
SCALE = 1:4000

Sibaji Maity
SIBAJI MAITY
KOLKATA MUNICIPAL CORPORATION
L.B.S.-1776(I)

SIBAJI MAITY L.B.S. NO. 1776 /I

SIGNATURE OF APPLICANTS

SIGNATURE OF L.B.S.